

VK0200TTK / VK112EUTTK

Control Pad / Keypad Tabletop Kit

Quick Start Guide

© Copyright 2023 ATEN® International Co. Ltd.
ATEN and the ATEN logo are registered trademarks of ATEN International Co., Ltd.
All rights reserved. All other trademarks are the property of their respective owners.
Released: 03/2023

A Hardware Overview

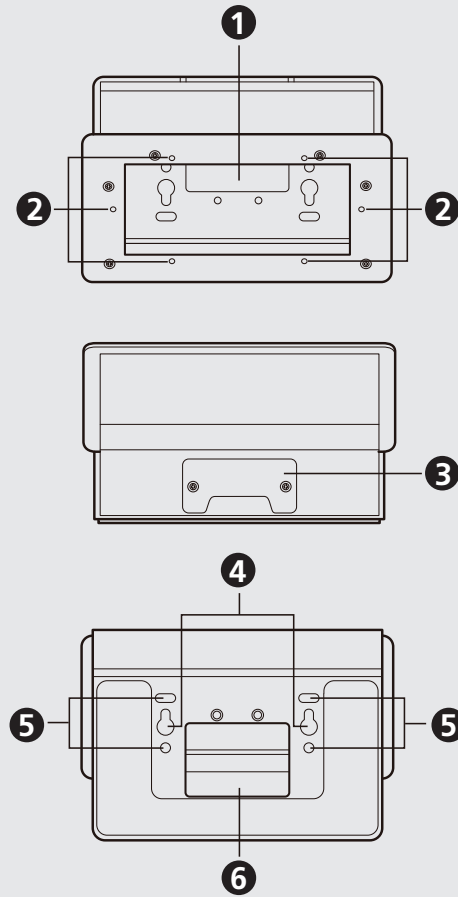

B Installation

Desktop Mount

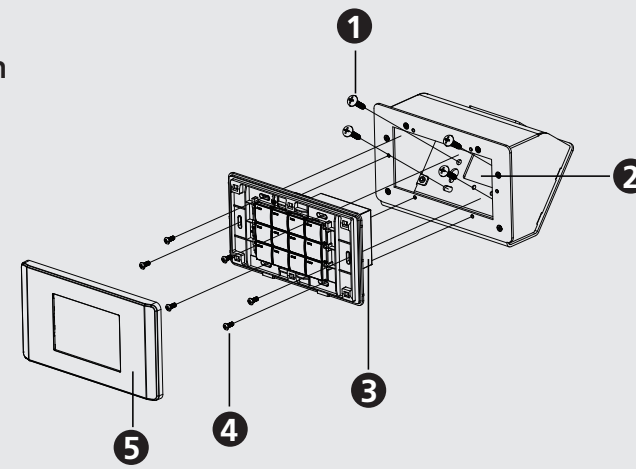

Wall Mount

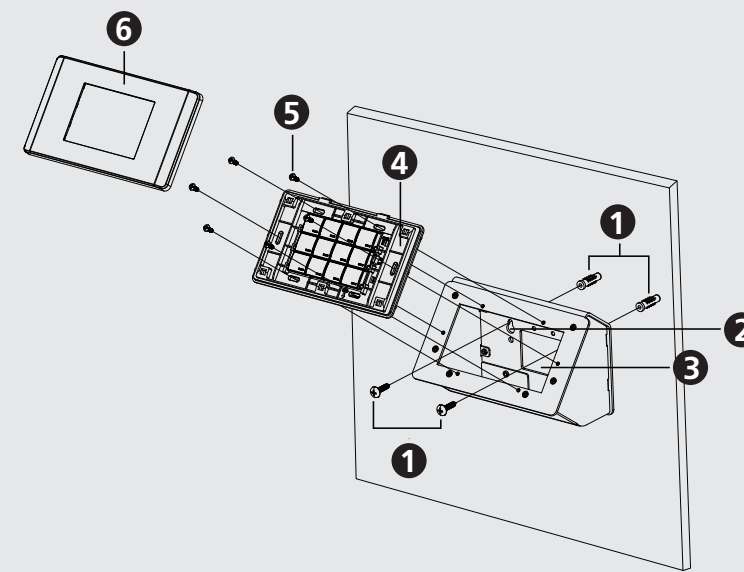

Package Contents

- 1 tabletop enclosure
- 4 anchors
- 4 M4x18 screws
- 6 M3x8 screws
- 1 user instructions

Support and Documentation Notice

All information, documentation, firmware, software utilities, and specifications contained in this package are subject to change without prior notification by the manufacturer.
To reduce the environmental impact of our products, ATEN documentation and software can be found online at <http://www.aten.com/download/>

Technical Support
www.aten.com/support

Scan for more information



VK0200TTK



VK112ETTK

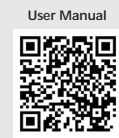

User Manual

A Hardware Overview

- 1 front knockout
- 2 M3x8 screw holes
- 3 rear knockout seal
- 4 wall-mount hook holes
- 5 M4x18 screw holes
- 6 bottom knockout

B Installation

Note: For your safety, always turn off the power before working on an enclosure.

Desktop Mount

- Place the enclosure on a desk where a hole is punched out to provide a path for wires. Optionally secure the enclosure to the desk with the four M4x18 screws provided.
- Depending on your application, run the cables through the rear or bottom knockout to the front knockout.
Note: The rear knockout can be fully covered. Loosen the 2 screws and rotate the knockout seal to make the notch upward to fully cover the hole. Secure it again with the 2 screws.
- Connect the required cables to the control pad / keypad.
Note: Please refer to the *Wiring Information* section of *ATEN Control System User Manual* for how to join the wires.
- Fold the wires into the enclosure and then secure the control pad / keypad with the six M3x8 screws provided.
- Install the buttons and faceplate to the control pad / keypad.

Wall Mount

- (Optional) To secure the enclosure to the wall, drill the pilot holes through the wall and put the 4 anchors in the wall in advance.
- With the rear side downwards, align the wall-mount holes to the pre-installed wall studs, and then attach the enclosure to the wall by mounting it to the wall studs. Optionally secure it with the four M4x18 screws provided.
- Depending on your application, run the cable from the rear or bottom knockout to the front knockout.
Note: The rear knockout can be fully covered. Loosen the 2 screws and rotate the knockout seal to make the notch upward to fully cover the hole. Secure it again with the 2 screws.
- Connect the cables to the control pad / keypad.
Note: Please refer to the *Wiring Information* section of *ATEN Control System User Manual* for how to join the wires.
- Fold the wires into the enclosure and then secure the control pad / keypad with the six M3x8 screws provided.
- Install the buttons and faceplate to the control pad / keypad.