

© Copyright 2026 ATEN® International Co., Ltd. ATEN and the ATEN logo are trademarks of ATEN International Co., Ltd. All rights reserved. All other trademarks are the property of their respective owners. This product is RoHS compliant.

Part No. PAPE-1223-N90G Printing Date: 05/2026



VC081 HDMI EDID Emulator www.aten.com

A Hardware Review

- 1 HDMI Out Port
- 2 Learning LED (Blue)
- 3 EDID LED (Green)
- 4 HDMI In Connector

B Hardware Installation (Learning EDID)

It is recommended that all equipment is powered during the steps below.

- 1 Connect an HDMI cable to an HDMI display.
- 2 Connect the HDMI cable to the HDMI Out Port of the emulator.
- 3 Plug the HDMI In Connector of the emulator into the HDMI source. The EDID LED lights green.
- 4 Disconnect the HDMI cable from the emulator. The Learning LED lights blue.
- 5 When the Learning LED starts flashing, reconnect the HDMI cable to the emulator's HDMI Out Port within 10 seconds.

Package Contents
 1 VC081 HDMI EDID Emulator
 1 User Instructions

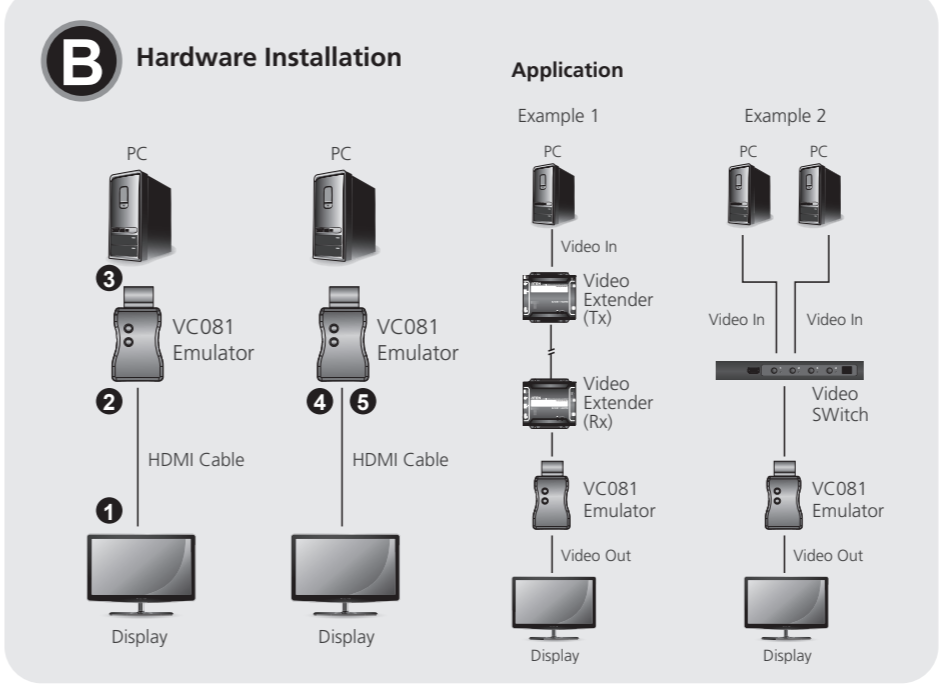
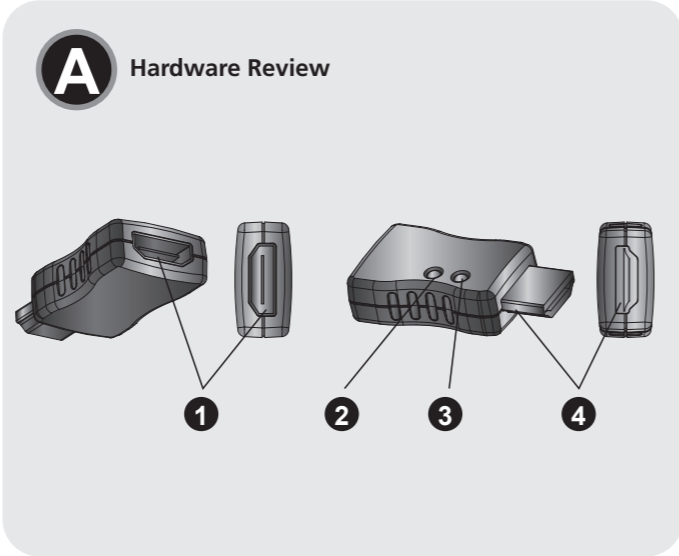

Support and Documentation Notice
 All information, documentation, firmware, software utilities, and specifications contained in this package are subject to change without prior notification by the manufacturer.
 To reduce the environmental impact of our products, ATEN documentation and software can be found online at <http://www.aten.com/download/>
Technical Support
www.aten.com/support

EMC Information
 FEDERAL COMMUNICATIONS COMMISSION INTERFERENCE STATEMENT:
 This equipment has been tested and found to comply with the limits for a Class B digital service, pursuant to Part 15 of the FCC rules. These limits are designed to provide reasonable protection against harmful interference in a residential installation. Any changes or modifications made to this equipment may void the user's authority to operate this equipment. This equipment generates, uses, and can radiate radio frequency energy. If not installed and used in accordance with the instructions, may cause harmful interference to radio communications. However, there is no guarantee that interference will not occur in a particular installation. If this equipment does cause harmful interference to radio or television reception, which can be determined by turning the equipment off and on, the user is encouraged to try the following measures:
 - Reorient or relocate the receiving antenna;
 - Increase the separation between the equipment and receiver;
 - Connect the equipment into an outlet on a circuit different from that to which the receiver is connected;
 - Consult the dealer/experienced radio/television technician for help.
FCC Caution: Any changes or modifications not expressly approved by the party responsible for compliance could void the user's authority to operate this equipment.
 This device complies with Part 15 of the FCC Rules. Operation is subject to the following two conditions: (1) this device must not cause harmful interference, and (2) this device must accept any interference received, including interference that may cause undesired operation.

이 기기는 가정용 (B급) 전자파적합기기로서 주로 가정에서 사용하는 것을 목적으로 하며, 모든 지역에서 사용할 수 있습니다.

The terms HDMI, HDMI High-Definition Multimedia Interface, HDMI trade dress and the HDMI Logos are trademarks or registered trademarks of HDMI Licensing Administrator, Inc.

Émulateur EDID HDMI VC081 www.aten.com

A Présentation du matériel

- 1 Port de sortie HDMI
- 2 LED d'apprentissage (Bleue)
- 3 LED EDID (Verte)
- 4 Connecteur d'entrée HDMI

B Installation du matériel (Apprentissage EDID)

Il est conseillé que tous les équipements soient alimentés pendant les étapes ci-dessous.

- 1 Raccordez un câble HDMI à un écran HDMI.
- 2 Raccordez le câble HDMI au port de sortie HDMI de l'émulateur.
- 3 Branchez le connecteur d'entrée HDMI de l'émulateur dans la source HDMI. La LED EDID s'allume en vert.
- 4 Débranchez le câble HDMI de l'émulateur. La LED d'apprentissage s'allume en bleu.

- 6 When both LEDs stay lit, the learning of the display's EDID is complete.

After the display's EDID is learnt, the emulator can also be used in place of a monitor to keep a PC or Server awake for remote access via IP.

Reset Emulator

Reset the emulator if EDID learning was unsuccessful. To reset, go through the steps 1-4 described in "Hardware Installation". When the LEDs dim, the emulator is reset.

Application

Examples of where the emulator should be placed when extenders or switches are involved are shown above: Please note that the emulator is always placed on the display end of the connection.

Émulateur EDID HDMI VC081

- 5 Lorsque la LED d'apprentissage commence à clignoter, rebranchez le câble HDMI au port de sortie HDMI de l'émulateur dans les 10 secondes.
- 6 Lorsque les deux LED restent allumées, l'apprentissage de l'EDID de l'écran est terminé.

Une fois l'apprentissage de l'EDID de l'écran effectué, l'émulateur peut également être utilisé à la place d'un moniteur pour maintenir un PC ou un serveur actif afin d'y accéder à distance via IP.

Réinitialisation de l'émulateur

Réinitialisez l'émulateur si l'apprentissage EDID a échoué. Pour réinitialiser, suivez les étapes 1 à 4 décrites dans "Installation du matériel". Lorsque les LED s'estompent, l'émulateur est réinitialisé.

Application

Des exemples d'emplacement de l'émulateur en présence de prolongateurs ou de commutateurs sont présentés ci-dessus : Veuillez noter que l'émulateur est toujours placé sur l'extrémité écran de la connexion.

HDMI-EDID-Emulator VC081 www.aten.com

A Hardwareübersicht

- 1 HDMI-Ausgang
- 2 Lern-LED (blau)
- 3 EDID-LED (grün)
- 4 HDMI-Eingang

B Hardware-Installation (Lern-LED)

Während der nachstehenden Schritte sollten alle Geräte mit Strom versorgt werden.

- 1 Verbinden Sie ein HDMI-Kabel mit einem HDMI-Display.
- 2 Verbinden Sie das HDMI-Kabel mit dem HDMI-Ausgang des Emulators.
- 3 Schließen Sie den HDMI-Eingang des Emulators an die HDMI-Quelle an. Die EDID-LED leuchtet grün.
- 4 Trennen Sie das HDMI-Kabel vom Emulator. Die Lern-LED leuchtet blau.
- 5 Wenn die Lern-LED zu blinken beginnt, schließen Sie das HDMI-Kabel innerhalb von 10 Sekunden erneut an den HDMI-Ausgang des Emulators an.

- 6 Wenn beide LEDs leuchten, ist das Lernen des Display-EDID abgeschlossen.

Nach Erlernen des Display-EDID kann der Emulator auch anstelle eines Monitors verwendet werden, um einen PC oder Server für Fernzugriff via IP aktiv zu halten.

Emulator zurücksetzen

Setzen Sie den Emulator zurück, falls der EDID-Lernen fehlgeschlagen ist. Durchlaufen Sie zum Zurücksetzen die unter „Hardware-Installation“ beschriebenen Schritte 1 bis 4. Wenn die LEDs erlöschen, wird der Emulator zurückgesetzt.

Anwendung

Beispiele für Positionen des Emulators, wenn Extender oder Switches involviert sind, werden oben gezeigt: Bitte achten Sie darauf, den Emulator immer am Displayende der Verbindung zu platzieren.

Emulador HDMI EDID VC081 www.aten.com

A Revisión de hardware

- 1 Puerto de salida HDMI
- 2 LED de aprendizaje (azul)
- 3 LED de encendido (verde)
- 4 Conector de Entrada HDMI

B Instalación de hardware (EDID de aprendizaje)

Se recomienda que todos los equipos estén conectados a la alimentados durante los pasos a continuación.

- 1 Conecte un cable HDMI a una pantalla HDMI.
- 2 Conecte el cable HDMI al puerto de Salida HDMI del emulador.
- 3 Enchufe el conector HDMI de Entrada del emulador a la fuente HDMI. El LED EDID se ilumina en verde.
- 4 Desconecte el cable HDMI del emulador. El LED de aprendizaje se ilumina en azul.
- 5 Cuando el LED de aprendizaje comience a parpadear, vuelva a conectar el

- 6 cable HDMI al puerto de salida HDMI del emulador dentro de 10 segundos. Cuando ambos LED permanezcan encendidos, se habrá completado el aprendizaje del EDID de la pantalla.

Una vez que se aprende el EDID de la pantalla, el emulador también se puede usar en lugar de un monitor para mantener activo un PC o un servidor para el acceso remoto a través de IP.

Restablecer el emulador

Restablezca el emulador si el aprendizaje de EDID no fue exitoso. Para reiniciar, siga los pasos 1 - 4 descritos en "Instalación del hardware". Cuando los LED se apagan, el emulador se reinicia.

Aplicación

Los ejemplos de dónde se debe colocar el emulador cuando se incorporan extensores o interruptores se muestran arriba: Tenga en cuenta que el emulador siempre se coloca en el extremo de visualización de la conexión.

Emulatore HDMI EDID VC081 www.aten.com

A Descrizione hardware

- 1 Porta HDMI Out
- 2 LED di apprendimento (blu)
- 3 LED EDID (verde)
- 4 Connettore HDMI In

B Installazione dell'hardware (EDID di apprendimento)

Si consiglia di alimentare tutte le apparecchiature durante i passaggi seguenti.

- 1 Collegare un cavo HDMI ad un display HDMI.
- 2 Collegare il cavo HDMI alla porta HDMI Out dell'emulatore.
- 3 Collegare il connettore HDMI In dell'emulatore nella sorgente HDMI. Il LED EDID si accende in verde.
- 4 Scollegare il cavo HDMI dall'emulatore. Il LED di apprendimento si accende in blu.
- 5 Quando il LED di apprendimento inizia a lampeggiare, ricollegare il cavo

- 6 HDMI alla porta HDMI Out dell'emulatore entro 10 secondi. Se il LED rimane acceso, l'apprendimento dell'EDID del display è completo.

Una volta appreso l'EDID del display, l'emulatore può anche essere utilizzato al posto di un monitor per mantenere attivo un PC o un server per l'accesso remoto tramite IP.

Ripristino emulatore

Ripristinare l'emulatore se l'apprendimento EDID non riesce. Per ripristinare, eseguire i passaggi 1-4 descritti in "Installazione dell'hardware". Quando i LED si attenuano, l'emulatore viene ripristinato.

Applicazione

Esempi del punto in cui l'emulatore deve essere posizionato quando sono coinvolti estensori o interruttori, come mostrato in precedenza: Si noti che l'emulatore è sempre posizionato sul lato display del collegamento.

Эмулятор HDMI EDID VC081 www.aten.com

A Обзор аппаратного обеспечения

- 1 Выходной порт HDMI
- 2 Индикатор обучения (синего цвета)
- 3 Индикатор EDID (зеленого цвета)
- 4 Входной разъем HDMI

B Установка аппаратного обеспечения (EDID обучения)

На время выполнения следующей процедуры рекомендуется включить питание всего оборудования.

- 1 Подключите кабель HDMI к дисплею HDMI.
- 2 Подключите кабель HDMI к выходному порту HDMI эмулятора.
- 3 Подключите входной разъем HDMI эмулятора к источнику сигнала HDMI. Индикатор EDID загорается зеленым цветом.
- 4 Отсоедините кабель HDMI от эмулятора. Индикатор обучения загорается синим цветом.
- 5 Когда индикатор обучения начнет мигать, снова подключите кабель HDMI к выходному порту HDMI эмулятора в течение 10 секунд.

- 6 Обучение EDID дисплея завершено, когда оба индикатора непрерывно светятся.

После изучения EDID дисплея эмулятор можно также использовать вместо монитора, чтобы поддерживать активность ПК или сервера для удаленного доступа через IP.

Сброс параметров эмулятора

Сброс параметров эмулятора выполняется, если обучение EDID прошло неудачно. Для сброса параметров выполните действия 1-4, описанные в разделе "Установка аппаратного обеспечения". Сброс параметров эмулятора завершен, когда индикатор перестает светиться.

Применение

Ниже приводятся примеры использования эмулятора с применением удлинителей или коммутаторов. Обратите внимание на то, что эмулятор должен располагаться со стороны дисплея.

